

# MEDIASCREEN 1

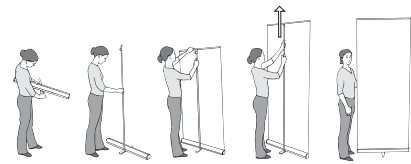

Slim, user-friendly retractable display.



The pole is now placed directly into the foot (instead of the base), which makes the design and size of the base more slender, as well as offering more product stability.

MediaScreen 1 is a slim, user-friendly retractable display with an attractive design, which accommodates your need to easily and quickly set-up your message. The telescopic pole also adds to the ease of set-up, allowing you to adjust the height of your graphic.

The clamping profile holds most graphic materials and attaches to the top of the telescopic pole. This attachment does not allow the pole to protrude above the image. You can set up MediaScreen 1 in 30 seconds. It weighs less than 10 lbs and is delivered in a practical nylon bag for easy transport and storage. An optional spotlight is also available to illuminate your message.

## INCLUDED

MediaScreen 1 base, graphic, telescopic pole, and nylon carrying bag

## VISIBLE SIZES

Width: 33-7/16" and 39-3/8"  
Height: Adjusts from 63" to 88-5/8"

## GRAPHIC CHOICES

Digital Photo Graphic  
Direct Digital (textiles, vinyl, specialty)  
Dye-Sub (fabrics)

## ADDITIONS

Spotlight - 50W (US standard)  
Shipping Case